

# -FUJIOH-

## HOOD /

### FR-LT2490 V

高い性能を、  
タッチレスで実現。

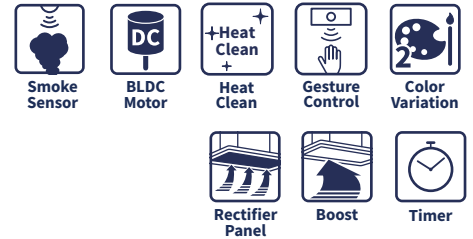

BK / Black

GR / Gray

## SPECIFICATIONS

Type	Ventilating
Hood Body	SPCC with Coated Paint
Filter	Fan Guard
Motor	BLDC Motor
Speed	3 Speeds & Boost Mode
Timer	3 mins
Oil Capturing Ratio [%]	86
Sound Level at 240V [dB]	48 - 52
Dimensions [mm]	W896 x D494 x H620 - 900
Duct Diameter [mm]	Φ190
RCP	WM RM3,498 EM RM3,698

## INSTALLATION DRAWING

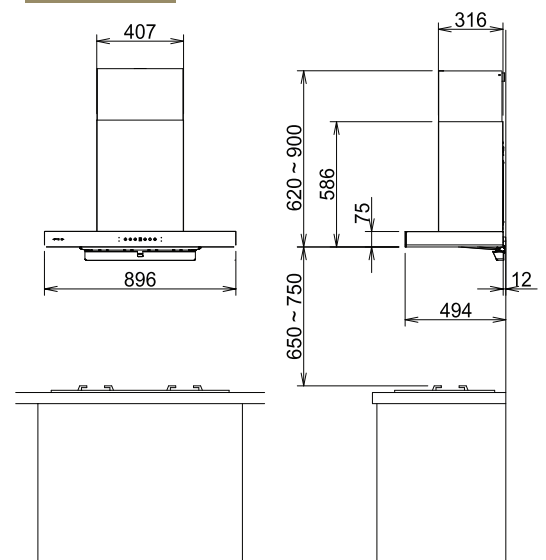

\* 4 years general warranty for motor and parts.

# ADVANCED FUNCTIONS



**Smart Intelligent Smoke Detector**

Smartly adjusts fan speed based on smoke levels.

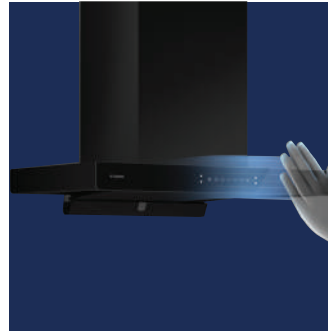

**Motion Sensing Operation**

Touch-free operation for convenience and hygiene.

## Hood & Hob Bundle Promotion



OR



any cooker hob

 <p><b>FH-GS2020 SVGL</b> Cut-Out Dimensions 650-655(W) x 350-355(D)</p> <p><b>RM3,888</b> RCP: RM4,596</p>	 <p><b>FH-GS2030 SVGL</b> Cut-Out Dimensions 685-690(W) x 405-410(D)</p> <p><b>RM4,188</b> RCP: RM4,896</p>	 <p><b>FH-GS3020 SVGL</b> Cut-Out Dimensions 650-730(W) x 350-410(D)</p> <p><b>RM4,288</b> RCP: RM5,096</p>	 <p><b>FH-GS3028 SVGL</b> Cut-Out Dimensions 690-830(W) x 390-470(D)</p> <p><b>RM4,388</b> RCP: RM5,196</p>	 <p><b>FH-GS3030 SVGL</b> Cut-Out Dimensions 690-830(W) x 390-470(D)</p> <p><b>RM4,588</b> RCP: RM5,396</p>
 <p><b>FH-GS6520 SVGL / SVSS</b> Cut-Out Dimensions 650-730(W) x 350-410(D)</p> <p><b>RM4,488</b> RCP: RM5,296</p>	 <p><b>FH-GS6528 SVGL</b> Cut-Out Dimensions 690-830(W) x 390-470(D)</p> <p><b>RM4,588</b> RCP: RM5,396</p>	 <p><b>FH-GS6530 SVGL / SVSS</b> Cut-Out Dimensions 690-830(W) x 390-470(D)</p> <p><b>RM4,788</b> RCP: RM5,596</p>	 <p><b>FH-GS7020 SVGL</b> Cut-Out Dimensions 650-720(W) x 350-410(D)</p> <p><b>RM4,988</b> RCP: RM5,796</p>	 <p><b>FH-GS7030 SVGL</b> Cut-Out Dimensions 700-800(W) x 400-430(D)</p> <p><b>RM5,288</b> RCP: RM6,096</p>
 <p><b>FH-ID5125</b> Cut-Out Dimensions 268(W) x 500(D)</p> <p><b>RM4,688</b> RCP: RM5,096</p>	 <p><b>FH-ID5120</b> Cut-Out Dimensions 570(W) x 375(D)</p> <p><b>RM4,788</b> RCP: RM5,296</p>	 <p><b>FH-ID5230</b> Cut-Out Dimensions 560(W) x 490(D)</p> <p><b>RM5,088</b> RCP: RM5,696</p>	 <p><b>FH-IC7020</b> Cut-Out Dimensions 680(W) x 380(D)</p> <p><b>RM5,088</b> RCP: RM5,696</p>	 <p><b>FH-IC7030</b> Cut-Out Dimensions 695(W) x 410(D)</p> <p><b>RM5,388</b> RCP: RM5,996</p>

Prices above are applicable to WM only. Additional charge of RM200 is applicable to purchases in EM. The above measurements are calculated in units of "mm".

